

Fountain Hills

RELOCATION GUIDE



CB COLDWELL
BANKER

stewart
TITLE



Christine Sullivan
REALTOR®

Debbie Weirich
REALTOR®

I am a seasoned REALTOR® and Luxury Property Specialist with Coldwell Banker, proudly serving Fountain Hills and surrounding Arizona communities. With over 25 years of executive-level business experience, I bring a powerful combination of strategic marketing insight and client-focused service to every transaction.

As a Fountain Hills resident for the past 13 years, I have developed a deep connection to the community and have devoted my time to serving in various leadership roles. This involvement, combined with my real estate expertise, gives me a strong and nuanced understanding of the local market. Fountain Hills is a truly unique community—comprised of approximately 80% custom homes—making experience and local knowledge essential when navigating real estate decisions here.

I am known for my thoughtful, tailored approach—carefully positioning each property, analyzing market trends, and negotiating with precision and professionalism. Whether working with first-time buyers, relocation clients, or luxury home sellers, I deliver a seamless, elevated experience built on trust, discretion, and results.

My background in leadership, marketing, and customer service allows me to create customized strategies that help my clients confidently achieve their real estate goals.

As part of a globally recognized brand, I offer both expansive reach and the attention and care of a dedicated local expert. My clients consistently describe me as responsive, transparent, and deeply committed—earning five-star reviews and a strong reputation throughout Fountain Hills and the greater Scottsdale area.

With over twenty years of experience in real estate, I offer a highly personalized and sophisticated approach to buying and selling homes. My career began in Illinois, and for the past seven years I have specialized in the Arizona market, where I've built a reputation for delivering exceptional results with discretion, professionalism, and care.

As a REALTOR® with Coldwell Banker, I am dedicated to providing a seamless, elevated experience tailored to each client. From luxury properties to thoughtfully guided relocations, I combine in-depth market knowledge with strong negotiation skills and a meticulous eye for detail. Having relocated myself, I understand the complexities and emotions that come with the process and specialize in helping clients transition with confidence and ease.

A key part of my approach includes offering refined, design-driven staging services—helping sellers present their homes at the highest level to maximize appeal and value. With a focus on creating warm, inviting, and aspirational spaces, I ensure each home stands out in today's competitive market.

Proudly based in Fountain Hills, I offer clients not only real estate expertise, but true local insight. My family is deeply rooted in the community—my children and grandchildren live nearby, and my husband owns a local jiu-jitsu gym—giving me a genuine connection to the lifestyle I represent.

I believe real estate is more than a transaction—it's a meaningful transition. I am committed to delivering an elevated level of service, trusted guidance, and a refined experience from start to finish.





About Coldwell Banker Realty

FOUNTAIN HILLS & SCOTTSDALE RELOCATION

Coldwell Banker Realty is one of the most recognized and respected names in real estate, offering a powerful advantage to clients relocating to the Fountain Hills and Scottsdale areas. With a legacy built on integrity, innovation, and results, the brand delivers a level of trust and professionalism that is essential when making a move to a new community.

Relocating to the Northeast Valley requires more than just a home search—it requires insight into the nuances of each neighborhood, lifestyle considerations, and long-term value. Coldwell Banker Realty differentiates itself by combining global reach with hyper-local expertise. Clients benefit from a network that spans the world, while working with highly knowledgeable agents who understand the unique dynamics of the Fountain Hills and Scottsdale markets.

The company is known for its commitment to agent education and excellence. Coldwell Banker Realty agents receive ongoing, advanced training in market analytics, negotiation strategy, and innovative marketing techniques. This ensures that clients are guided by professionals who are not only experienced, but exceptionally well-prepared to navigate today's competitive and ever-changing market.

In communities like Fountain Hills—where a significant portion of homes are custom-built—this expertise becomes even more critical. Understanding construction quality, architectural differences, lot positioning, and long-term investment potential requires a seasoned approach. Coldwell Banker Realty agents bring this level of insight, helping relocation clients make informed, confident decisions.

Clients can expect a seamless, concierge-level experience from start to finish. From personalized home searches and virtual tours to strategic offer guidance and closing coordination, every step is handled with precision, transparency, and care. The goal is not just to find a home—but to ensure a successful transition into a new lifestyle.

Above all, Coldwell Banker Realty is known for its unwavering commitment to integrity. Clients consistently choose the brand for its professionalism, ethical standards, and dedication to putting their best interests first.

For those relocating to Fountain Hills or Scottsdale, Coldwell Banker Realty offers the ideal balance: the strength of a globally recognized brand and the trusted guidance of a deeply connected local expert.

16872 E Avenue of the Fountains #101, Fountain Hills, AZ 85268
(480) 951-1010



The Confidence You Need

The Partner You Trust

Peace of mind comes from more than a successful closing, it comes from knowing every step of your transaction is handled with integrity, care and efficiency.

At Stewart Title, we're committed to giving you the confidence of a trusted partner who brings clarity, security and assurance to every closing. Our combination of global expertise and local knowledge means you always have a partner who understands your market and your clients. And our industry-leading wire fraud prevention with CertifID helps safeguard your clients and your reputation. Here, peace of mind isn't just a promise, it's the result of the way we work for you and your business.

Work with the team that protects what matters most.

TABLE OF CONTENT

FOUNTAIN HILLS TOWN MAP	6-7
CONDO COMMUNITIES	8
FOUNTAIN HILLS, ARIZONA	9
SCOTTSDALE, ARIZONA	10
TRILOGY AT VERDE RVER	11
HIDDEN HILLS COMMUNITY	12
SUNRIDGE CANYON COMMUNITY	13
EAGLE MOUNTAIN GOLF CLUB	14
DESERT CANYON GOLF CLUB	15
SCOTTSDALE MOUNTAIN COMMUNITY	16
CRESTVIEW COMMUNITY	17
EAGLES NEST COMMUNITY	18
FIRE ROCK COMMUNITY	19
TONTO VERDE COMMUNITY	20
NORTH HEIGHT NEIGHBOURHOOD	21
LAKESIDE VILLAGE COMMUNITY	22
ANCALA COUNTRY CLUB	23
YEARLY COMMUNITY EVENTS	24
AREA GOLF COURSES	25
SHOPPING & MALLS	26
NEARBY RESORTS	27
MUSEUMS ●	28-29
HIKING TRAILS	30
NEARBY ATTRACTIONS	31-32

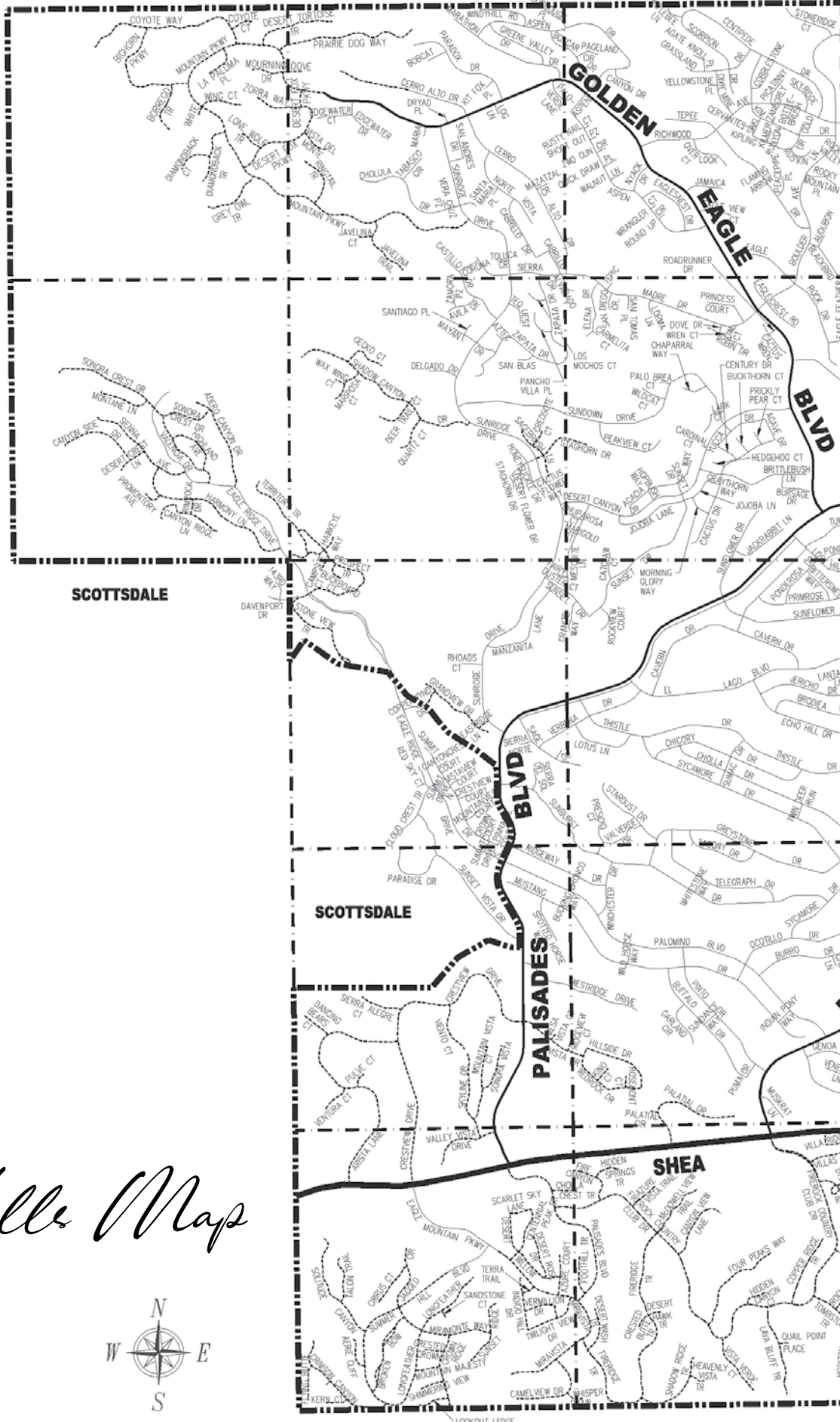

Fountain Hills Map



SCALE OF MILES

SALT RIVER PIMA - MARICOPA

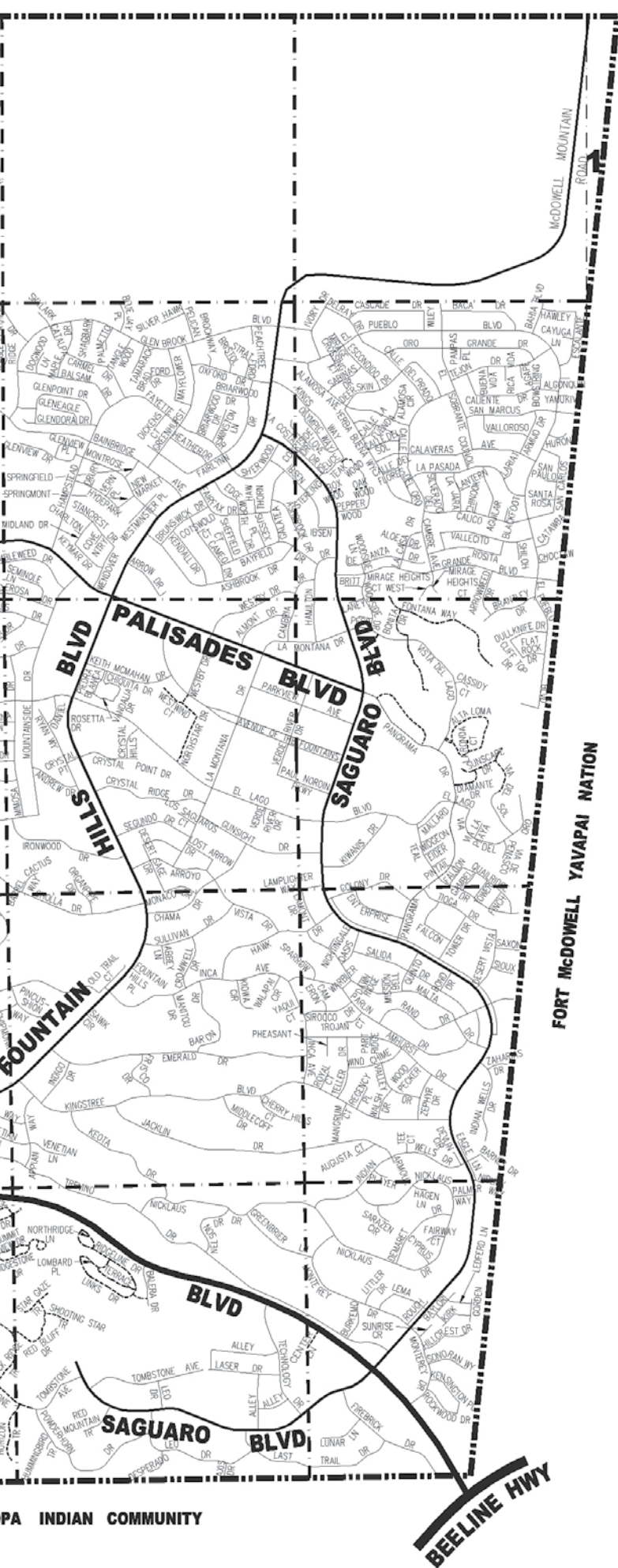



Condo Communities

The condo market includes everything from affordable older units to upscale luxury properties with resort-style amenities, with many communities offering pools, gated access, and views of the surrounding desert landscape. Most condominiums are located near shopping, dining, golf, and outdoor recreation, and the area is valued for its quieter pace compared with central Phoenix while still providing convenient access to the broader metro area.

For more information, please go to: christineasullivan.sites.cbmoxi.com

- | | |
|---|----------------------------|
| La Strada | The Villas at CopperWynd |
| Plaza del Lago | La Montana Townhomes |
| Plaza Del Lago Condominiums | The Overlook at FireRock |
| Four Peaks Condominiums | Courtside Casitas |
| Villas At Club Mirage | Desert Sage Condominiums |
| Fountain Mist Townhomes Condominiums | Fountainhead |
| Villa Estates At Town Center Condominiums | Casa Bella |
| Thunder Ridge Condominiums | Monterra Ranch |
| Shadow Canyon | Crystal Ridge Condominiums |
| Four Peaks Vista | Colony Pointe |
| Firerock Resort Casitas | Sunridge Villas |
| Balera at Firerock | Ridgeview Casitas |
| Village at Towne Center | Vista Mayan |
| Terrace at Fountain Hills | Emerald Mesa Condominiums |
| Mirage Crossing | Fountain Hills Manor |
| Eagle Mountain Villas | Villas at La Montana |
| Glenbrook Condominiums | Villa d'Este |
| Saguaro Woods | Courtside Terrace |
| Courtside Villas | Park Place Villas |
| El Lago Village | Ridgestone Villas |
| Park Palisades | Adero Villas |
| Fountain View | |



Fountain Hills, Arizona

The Town of Fountain Hills is a master planned community established in 1970. Fountain Hills was named after the towering man-made fountain in the center of town. Built in 1970, it is the fourth-tallest in the world, reaching 560 feet in height. Incorporated in 1989, Fountain Hills is home to nearly 24,000 residents. Located on 13,006 acres of land, Fountain Hills is surrounded by the 3,500-foot McDowell Mountains and Scottsdale on the west, the Fort McDowell Yavapai Nation on the east, the Salt River Pima Maricopa Indian Community on the south and the McDowell Mountain Regional Park on the north. The elevation is 1,520 feet at the fountain, 3,000 feet on Golden Eagle Boulevard, and is 500 feet above Phoenix and covers 24 square miles.

Prior to 1970 the area was a cattle ranch and was part of one of the largest land and cattle holdings in Arizona. The land was purchased by Robert McCulloch in the late 1960s and the community designed by Charles Wood, Jr. (designer of Disneyland in southern California). 1 One of the community's most valuable assets is its natural beauty. Incredible views and natural desert terrain provide for a wide range of outdoor activities including hiking, biking, and golf.



Scottsdale, Arizona

Scottsdale is a prominent city in the eastern part of the Phoenix metropolitan area, known for its mix of luxury living, desert landscapes, and vibrant tourism industry. Originally founded in the late 19th century, Scottsdale has grown into one of Arizona's most desirable cities, offering a high quality of life with well-planned neighborhoods, strong economic development, and a reputation for cleanliness and safety.

The city is especially famous for its resorts, spas, and golf courses, attracting visitors from around the world. Areas like Old Town Scottsdale showcase a blend of historic charm and modern entertainment, with art galleries, boutiques, restaurants, and a lively nightlife scene. Scottsdale also hosts numerous cultural events and festivals throughout the year, contributing to its identity as a center for arts and leisure.

Outdoor recreation is a major part of life in Scottsdale, thanks to its location in the Sonoran Desert. The McDowell Sonoran Preserve offers miles of hiking and biking trails, allowing residents and visitors to experience the region's natural beauty. The city's sunny

climate and scenic surroundings make it ideal for year-round outdoor activities.

In addition to tourism, Scottsdale has a strong local economy supported by healthcare, technology, and retail sectors. It is often associated with affluence, featuring upscale shopping centers, luxury homes, and fine dining. Overall, Scottsdale blends modern sophistication with Southwestern character, making it both a popular travel destination and a sought-after place to live.



Trilogy at Verde River is a resort-style master-planned community located in Rio Verde, just northeast of Scottsdale. Set against the backdrop of the Sonoran Desert and near the Tonto National Forest, the community is known for its scenic mountain views, quiet surroundings, and access to outdoor recreation. Its more remote location offers a peaceful alternative to the busier urban areas nearby.

Developed primarily by Shea Homes, the neighborhood features modern single-family homes with contemporary designs and a range of sizes and price points. The community is gated and maintained with an HOA, contributing to its well-kept appearance and cohesive feel. While often attracting 55+ buyers, it is not strictly age-restricted.

At the center of Trilogy at Verde River is the Verde River Golf & Social Club, which anchors the lifestyle with amenities such as a championship golf course, resort-style pools, fitness and spa facilities, dining venues, and courts for sports like pickleball and tennis. Residents have access to a wide variety of clubs, classes, and social events, creating a highly active and community-oriented environment.

Overall, Trilogy at Verde River offers an upscale, resort-like lifestyle in a beautiful desert setting, combining modern homes, extensive amenities, and a vibrant social atmosphere.



Tucked into the serene desert landscape of North Scottsdale, Hidden Hills is a sought-after community known for its peaceful atmosphere, spacious homes, and stunning views of the surrounding mountains and Sonoran Desert. The neighborhood offers a sense of privacy and retreat while remaining conveniently close to Scottsdale's premier golf courses, hiking trails, upscale dining, shopping, and entertainment. With its quiet streets, natural desert beauty, and beautifully designed homes, Hidden Hills embodies the relaxed sophistication that defines Scottsdale living.

Residents of Hidden Hills enjoy a lifestyle centered around outdoor living, breathtaking sunsets, and a strong connection to the Arizona landscape. Many homes feature expansive patios, resort-style outdoor spaces, and panoramic desert vistas that create an ideal setting for both relaxation and entertaining. The community's blend of tranquility, accessibility, and timeless Southwestern character makes Hidden Hills a desirable destination for those seeking comfort, beauty, and an elevated desert lifestyle in Scottsdale, Arizona.



Sunridge Canyon Community is a master planned community developed in 1996 and consists of 788 homesites within the Fountain Hills master planned community. The 959 acre community currently has 33 undeveloped homesites (19 in the Shadow Canyon neighborhood and 14 in the Master Community at large.) The area features breathtaking views in every direction providing every home with pure natural desert beauty as a backdrop including a glimpse of the McDowell Mountains, Red Mountain, Superstition Mountains and Four Peaks.

This community features 15 separate neighborhoods of single-family homes built around the SunRidge Canyon Golf Course, which weaves its way through the community and is privately owned and operated. Two neighborhoods, Solitude and Shadow Canyon, are the only two which are gated. The SunRidge Canyon community is bordered by open space owned by the Town of Fountain Hills, the neighborhoods of North Heights and Sierra Madre Estates, and Golden Eagle Park. A majority of the homes were built by Golden Heritage, Del Mar, Edmunds, and Greystone and includes single family homes ranging from 1,462sq ft and

larger on lots of up to one acre. Included in the community are additional roadway, drainage and natural open space areas which are managed by the SunRidge Canyon Community Association, the SunRidge Canyon Golf Course or the Town of Fountain Hills. All private lots are owned and managed by the individual property owner with oversight assistance from the Community Association for the open space and common areas.



Eagle Mountain Golf Club

Set against the breathtaking backdrop of the McDowell Mountains and Sonoran Desert, Eagle Mountain is one of Fountain Hills' most sought-after gated golf communities, offering an exceptional blend of luxury, tranquility, and natural beauty. The community is known for its elevated homesites, dramatic desert vistas, and beautifully maintained streets that wind through the rugged Arizona landscape. Residents enjoy a peaceful atmosphere with convenient access to nearby hiking trails, upscale dining, shopping, and the charming heart of Fountain Hills, all while being just a short drive from Scottsdale.

At the center of the community is the acclaimed Eagle Mountain Golf Club, a championship course celebrated for its stunning views and unforgettable desert golf experience. Homes within Eagle Mountain embrace Arizona's indoor-outdoor lifestyle, with expansive patios, resort-style outdoor living spaces, and panoramic sunset views. Whether enjoying a morning on the golf course, exploring the surrounding desert trails, or relaxing beneath the glow of the mountain skyline, residents experience a lifestyle defined by elegance, recreation, and the timeless beauty of the Southwest.



Desert Canyon Golf Club

Located near the scenic Desert Canyon Golf Club, the neighborhood affectionately known as Desert Canyon offers a relaxed and welcoming lifestyle surrounded by the natural beauty of Fountain Hills. Framed by rolling desert terrain, mountain views, and lush golf course landscapes, this area is beloved for its peaceful atmosphere, mature surroundings, and convenient location close to shopping, dining, hiking trails, and Fountain Hills' vibrant community events. Residents enjoy a quieter pace of life while remaining connected to everything that makes Fountain Hills such a desirable place to live.

Desert Canyon is especially appreciated for its authentic Arizona charm and easygoing sense of community. Homes throughout the area embrace the indoor-outdoor lifestyle that defines desert living, with many properties offering golf course views, spacious patios, and breathtaking sunsets over the surrounding mountains. Whether enjoying an early morning walk, a round of golf, or evenings beneath the desert sky, residents are drawn to the neighborhood's comfort, beauty, and timeless appeal. Desert Canyon captures the essence of casual luxury and the laid-back spirit of Fountain Hills living.



Scottsdale Mountain Community

Scottsdale Mountain is an upscale, guard-gated residential community located in the foothills of the McDowell Mountains in Scottsdale. Developed primarily in the 1990s, it sits just north of Shea Boulevard near Fountain Hills, offering a private, elevated setting with sweeping views of the surrounding desert, mountains, and city lights.

The neighborhood consists mainly of single-family homes, along with some townhomes and custom estates, many designed to maximize panoramic views. Architectural styles are typically contemporary or Southwest-inspired, with spacious layouts, high ceilings, and upscale finishes. Homes range widely in size, appealing to both full-time residents and second-home buyers seeking a “lock-and-leave” lifestyle.

Residents enjoy amenities such as a 24-hour guard gate, tennis courts, spa facilities, and close access to hiking and biking trails in the nearby preserves. The community emphasizes privacy, scenic beauty, and outdoor living, while still being a short drive from Scottsdale’s shopping, dining, and healthcare hubs like the Mayo Clinic.

Overall, Scottsdale Mountain is known for combining luxury living with a quiet desert setting,

making it a popular choice for buyers who want security, views, and proximity to nature without being far from city conveniences.



Crestview Community

Nestled within the scenic desert landscape of Fountain Hills, Crestview is a quiet and inviting community known for its beautiful surroundings, well-maintained homes, and relaxed Arizona lifestyle. Residents enjoy picturesque mountain views, peaceful streets, and close proximity to many of the area's most desirable amenities, including golf courses, hiking trails, Fountain Park, and the charming shops and restaurants of downtown Fountain Hills. The neighborhood offers a welcoming atmosphere that blends comfort, convenience, and the natural beauty of the Sonoran Desert.

Crestview appeals to homeowners seeking a balance of tranquility and accessibility, with homes designed to embrace indoor-outdoor living and Arizona's year-round sunshine. Whether enjoying colorful desert sunsets, nearby recreation, or the strong sense of community that Fountain Hills is known for, residents experience a lifestyle centered around connection, relaxation, and scenic beauty. Crestview captures the essence of desert living with a warm neighborhood feel and timeless Southwestern charm.



Set within the untouched beauty of the high Sonoran Desert, Eagle's Nest is one of Fountain Hills' most prestigious custom home communities, known for its expansive homesites, breathtaking mountain views, and unmatched sense of privacy. Located at one of the highest elevations in Fountain Hills, this gated enclave offers sweeping panoramas of Four Peaks, the McDowell Mountains, Red Mountain, and sparkling city lights below. The community is thoughtfully designed to preserve the natural desert landscape, creating a serene environment where luxury living and nature exist in harmony.

Eagle's Nest is especially appealing to those seeking architectural distinction, tranquility, and space to create extraordinary custom residences. With nearby access to hiking, golf, Scottsdale amenities, and the vibrant heart of Fountain Hills, residents enjoy both seclusion and convenience. The community's elevated setting provides cooler temperatures, stunning sunsets, and a true connection to Arizona's rugged desert beauty. Eagle's Nest offers a lifestyle defined by sophistication, privacy, and the timeless allure of the Southwest.



Fire Rock Community

Perched high above the Sonoran Desert, FireRock Country Club is one of Fountain Hills' most exclusive luxury communities, offering an extraordinary blend of natural beauty, privacy, and elevated desert living. Known for its dramatic custom homes, sweeping mountain vistas, and breathtaking sunsets, FireRock is centered around a world-class private golf course designed to complement the rugged desert terrain. The gated community features winding hillside streets, striking architecture, and an atmosphere that feels both serene and sophisticated, attracting residents who value luxury, tranquility, and an active lifestyle.

Beyond its stunning homes and panoramic views, FireRock offers a true sense of connection to the Arizona landscape. Residents enjoy close proximity to hiking trails, outdoor recreation, and the vibrant arts, dining, and community events of Fountain Hills, while still enjoying the exclusivity and peacefulness of a private enclave. The FireRock Country Club serves as the social heart of the community, offering golf, dining, fitness, and gathering spaces that foster connection and recreation. With its refined desert elegance and unmatched scenery, FireRock represents the pinnacle of luxury living in Fountain Hills, Arizona.



Tonto Verde Community

Tonto Verde is a small, upscale residential community located northeast of Scottsdale, near the edge of the metropolitan Phoenix area. Nestled in the Sonoran Desert, it offers a quiet, scenic environment defined by mountain views, open space, and a strong emphasis on outdoor living. The community is closely associated with nearby areas like Rio Verde, but maintains its own identity as a more private, golf-oriented enclave.

Tonto Verde is primarily known as an active adult and retirement community, with many residents drawn by its peaceful atmosphere and resort-style amenities. The area centers around Tonto Verde Golf Club, which features championship golf courses, dining, and social activities. Homes in Tonto Verde are typically well-maintained and often designed to take advantage of the surrounding desert landscape, with views of nearby mountains and natural terrain.

Unlike larger cities, Tonto Verde has very limited commercial development, contributing to its quiet and residential character. Residents generally rely on nearby Scottsdale or Fountain Hills for shopping, healthcare, and entertainment. This

separation from urban density is a key part of the community's appeal, though it also means a more car-dependent lifestyle.

Outdoor recreation plays a central role in daily life. The community is located near expansive natural areas such as Tonto National Forest and McDowell Mountain Regional Park, providing opportunities for hiking, biking, and wildlife viewing. The mild winter climate makes it especially attractive to seasonal residents seeking to enjoy outdoor activities year-round.

Overall, Tonto Verde is best suited for those looking for a quiet, scenic, and amenity-focused lifestyle, particularly retirees or seasonal residents who value golf, nature, and a slower pace of living while still being within reach of the greater Phoenix area.



North Heights Neighborhood

North Heights in Fountain Hills is a residential neighborhood made up mostly of larger single-family homes built from the late 1980s through newer construction in the 2000s and beyond. Homes here tend to be on the upper end of the local market, often featuring bigger square footage, multiple bedrooms, and desert or mountain views. The area sits on the north side of town, so it feels a bit more tucked away and elevated compared to neighborhoods closer to the center

The overall vibe is quiet, suburban, and more upscale, with low HOA fees (or sometimes none) and a focus on privacy and space. It appeals to people looking for larger homes, newer builds, and a quieter setting. Compared to places like Lakeside Village near the lake, North Heights is less about walkability and amenities and more about space, views, and residential calm.



Lakeside Village Community

Lakeside Village (often called Fountainhead at Lakeside Village) in Fountain Hills is a gated condo and townhome community located near Fountain Park and its well-known lake. Built primarily in the late 1980s through the 1990s, it offers moderately sized units—typically two-bedroom layouts—with some properties featuring views of the lake or surrounding desert hills. The setting is quiet and residential, with a focus on low-maintenance living, making it especially appealing for retirees or seasonal homeowners.

The community includes amenities like a pool, spa, and shared outdoor areas, with an HOA that handles exterior maintenance and landscaping. While the location offers scenic surroundings and proximity to the town's main attraction, the homes reflect their older construction era. Overall, it's best suited for those looking for a peaceful, established neighborhood with manageable upkeep rather than newer builds or a more active, urban lifestyle.



Ancala Country Club

Ancala Country Club is a private, upscale country club located in the foothills of the McDowell Mountains in Scottsdale. Established around 1990, it serves as the centerpiece of the Ancala residential community, offering a blend of luxury recreation, social life, and scenic desert surroundings.

The club is best known for its 18-hole championship golf course designed by Perry Dye, featuring a challenging, target-style layout with mountain views and well-maintained desert terrain. Beyond golf, Ancala provides a full range of amenities including tennis courts, a swimming pool, fitness center, dining venues, and a busy calendar of social events and activities for members.

As a private, member-only club, access is limited to members and their guests, with various membership options (golf, sports, and social) available for individuals, families, and seasonal residents. The club emphasizes a family-friendly, community-oriented atmosphere, making it appealing not just to golfers but to those seeking an active lifestyle with social engagement and resort-style amenities.

Overall, Ancala Country Club is known for combining challenging golf, upscale amenities, and a strong social environment in a scenic North Scottsdale setting, making it one of the more established private clubs in the area.



Yearly Community Events

Fountain Festival of Fine Arts & Crafts

Spring and Fall, typically February and November

One of the largest arts and crafts fairs in the Southwest, featuring nearly 500 artists and artisans. Held along the Avenue of the Fountains, it showcases a wide range of mediums, from paintings to sculptures, alongside gourmet food vendors and live music.

Art on the Avenue

January through April, weekly

A weekly outdoor gallery where local and Valley artists display their work along the Avenue of the Fountains. Visitors can browse unique pieces while enjoying the scenic backdrop of the famous fountain, making it a relaxed cultural experience.

Fountain Hills Music Festival

Spring, typically April

A family-friendly outdoor event at Fountain Park featuring four live musical performances. Attendees bring blankets and chairs to enjoy food trucks, a beer garden by Bone Haus Brewing, and wine from Grapeables Wine Bar under Arizona's spring skies.

Dark Sky Festival

Spring, date varies

Celebrating Fountain Hills' status as an International Dark Sky Community, this free event includes stargazing with telescopes, live nocturnal animal displays, student art contests, live music, food trucks, and a beer and wine garden.

Thanksgiving Day Parade

November

A beloved local tradition drawing spectators statewide, this parade starts at 9:30 a.m. and lasts about an hour. It includes floats, marching bands, dance groups, and Santa Claus as the grand finale, kicking off the holiday season with flair.

Stroll in the Glow

December

A magical holiday event where the Avenue of the Fountains is illuminated with thousands of twinkling lights. Features 25 decorated holiday tree displays, Santa visits, live music, craft stations, and hot cocoa, creating a festive atmosphere for all ages.

Ballet Under the Stars

Fall, date varies

A free outdoor performance by professional ballet dancers set against the Arizona night sky. Attendees bring blankets or chairs to enjoy this elegant cultural experience in a relaxed, open-air setting.

Farmers Market

November to April on Wednesday

Features over 60 vendors offering fresh produce, artisan breads, pastries, gluten-free, vegan, vegetarian, and ethnic foods, plus food trucks and live music. The market is pet-friendly, handicap-accessible, and has free parking. 16831 E. Avenue of the Fountains, alongside Art on the Avenue.



SunRidge Canyon Golf Club

13100 N Sunridge Dr
Fountain Hills, AZ 85268
(480) 837-5100
www.sunridgegolf.com

Eagle Mountain Golf Club

14915 Eagle Mountain Pkwy
Fountain Hills, AZ 85268
(480) 816-1234
www.eaglemtn.com

Desert Canyon Golf Club

10440 N Indian Wells Dr
Fountain Hills, AZ 85268
(480) 837-1173
www.desertcanyongolf.com

FireRock Country Club (Private)

1600 E Firerock Country Club Dr
Fountain Hills, AZ 85268
(480) 836-8100
www.firerockcc.com/

We-Ko-Pa Golf Club

18200 E WeKoPa Way
Fort McDowell, AZ 85264
(480) 836-9000
wekopa.com

Ancala Country Club (Private)

11700 E Vía Linda
Scottsdale, AZ 85259
(480) 391-1000
www.ancalacc.com

Grayhawk Golf Club

8620 E Thompson Peak Pkwy
Scottsdale, AZ 85255
(480) 502-1800
grayhawkgolf.com

Kierland Golf Club

15636 N Clubgate Dr
Scottsdale, AZ 85254
(480) 922-9283
www.kierlandgolf.com

Gainey Ranch Golf Club (Private)

7600 Gainey Club Dr
Scottsdale, AZ 85258
(480) 951-0022

TPC Scottsdale

17020 N Hayden Rd
Scottsdale, AZ 85255
(480) 585-4334
tpc.com/scottsdale/

Stonecreek Golf Club

4435 E Paradise Village Pkwy S
Phoenix, AZ 85032
(602) 953-9111
stonecreekgc.com

McDowell Mountain Golf Club

10690 E Sheena Dr
Scottsdale, AZ 85255
(480) 502-8200
mcdowellmountaingc.com

Wildfire Golf Club

5350 E Marriott Dr
Phoenix, AZ 85054
(888) 705-7775
www.marriott.com/en-us/hotels/phxdr-jw-marriott-phoenix-desert-ridge-resort-and-spa/golf/



Shopping & Malls

Plaza Fountainside Merchants

12645 N Saguaro Blvd
Fountain Hills, AZ
(480) 836-0208

Main local shopping plaza near the fountain with restaurants, shops, and services

plazafountainside.com

Plaza Fountainside Merchants

16605 E Palisades Blvd # 114
Fountain Hills, AZ 85268
(480) 836-0208

Mix of small retail, dining, and everyday services

www.whitstonereit.com/

communities/?propertyId=phoenix-az-fountain-hills-plaza

Kierland Commons

15210 N Scottsdale Rd
Scottsdale, AZ
(480) 816-1234

Upscale outdoor shopping with boutiques, restaurants, and nightlife

www.eaglemtn.com

Scottsdale Fashion Square

7014 E Camelback Rd
Scottsdale, AZ
(480) 941-2140

Largest luxury mall in Arizona with high-end brands and dining

www.kierlandcommons.com

Scottsdale Quarter

15279 N Scottsdale Rd
Scottsdale, AZ
(480) 270-812

Modern luxury shopping + dining; constantly adding new retailers

scottsdalequarter.com

The Shops at Norterra

2460 W Happy Valley Rd
Phoenix, AZ
(480) 387-5678

Large open-air center with retail, restaurants, and entertainment

theshopsatnorterra.com

Superstition Springs Center

6555 E Southern Ave
Mesa, AZ 85206
(480) 832-0212

Major indoor mall with 170+ stores and anchor retailers

www.superstitionsprings.com

The Pavilions at Talking Stick

9120 E Talking Stick Way
Scottsdale, AZ
(480) 834-8500

Large open-air center with casual shopping, dining, and entertainment

www.thepavilionsattalkingstick.com

Biltmore Fashion Park

2502 E Camelback Rd, Phoenix
(602) 955-8400

Upscale outdoor mall with luxury brands and dining

www.reddevelopment.com/biltmore-fashion-park/



Nearby Resorts

ADERO Scottsdale Resort, Autograph Collection

13225 N Eagle Ridge Dr
Scottsdale, AZ 85268
480-333-1900

A modern luxury resort perched in the McDowell Mountains, known for panoramic desert views and dark-sky stargazing. It offers a full spa, fitness center, pools, tennis/pickleball, and upscale dining. Ideal for a quiet, scenic, high-end stay.

www.marriott.com/en-us/hotels/phxaf-adero-scottsdale-autograph-collection/overview/

We-Ko-Pa Casino Resort

10438 Wekopa Way
Fort McDowell, AZ 85264
480-789-5300

Located just outside Fountain Hills, this resort combines a casino, golf courses, dining, and desert views. Popular for entertainment-focused stays with a resort feel.

www.wekopacasinoresort.com

Talking Stick Resort

9800 E Talking Stick Way
Scottsdale, AZ 85256
480-850-7777

A large, upscale resort featuring a casino, multiple pools, nightlife, restaurants, and entertainment venues. Great if you want a more active, social environment.

www.talkingstickresort.com

The Scottsdale Resort and Spa, Curio Collection by Hilton

7700 E McCormick Pkwy
Scottsdale, AZ 85258
480-991-9000

This is a AAA Four-Diamond resort in central Scottsdale, located in the McCormick Ranch area. It features a large resort-style layout with pools, spa (Luna Spa), golf access nearby, and multiple restaurants, making it a full-service stay for both relaxation and events.

www.hilton.com/en/hotels/phxssqg-the-scottsdale-resort-and-spa/

Omni Scottsdale Resort & Spa at Montelucia

4949 E Lincoln Dr
Scottsdale, AZ 85253
(480) 627-3200

Spanish-style luxury resort at the base of Camelback Mountain

www.omnihotels.com/hotels/scottsdale-montelucia

Andaz Scottsdale Resort & Bungalows

6114 N Scottsdale Rd
Scottsdale, AZ 85253
(480) 368-1234

Modern desert resort with private bungalow-style rooms

www.hyatt.com/en-US/hotel/arizona/andaz-scottsdale-resort-and-bungalows

The Scott Resort & Spa

4925 N Scottsdale Rd
Scottsdale, AZ 85251
(480) 945-7666

Boutique resort with tropical-style pool and upscale vibe/

www.thescottresort.com

Arizona Grand Resort & Spa

8000 S Arizona Grand Pkwy
Phoenix, AZ 850441
(877) 800-4888

Large family resort with water park, golf course, spa

www.arizonagrandresort.com



Museums

River of Time Museum & Exploration Center

12901 N La Montana Dr #4742
Fountain Hills, AZ 85268
(480) 837-2612

The main museum in Fountain Hills, focused on local history, Native American culture, and the development of the region. Exhibits cover everything from early desert life to the town's founding and surrounding geography.

www.riveroftime.center

Phoenix Art Museum

1625 N Central Ave
Phoenix, AZ 85004
(602) 257-1880

The largest art museum in the Southwest, featuring global collections (American, Asian, European, modern) plus rotating exhibits and events.

<https://phxart.org/>

Museum of Illusions Scottsdale

9500 E Via De Ventura
Scottsdale, AZ 85256
(720) 769-6505

Interactive, hands-on museum with optical illusions and immersive exhibits—more entertainment-focused and great for photos or families.

www.moiscottsdale.com

Superstition Mountain – Lost Dutchman Museum

Address: 4087 E Apache Trail
Apache Junction, AZ 85119
(480) 983-4888

A regional history museum centered on the Lost Dutchman gold mine legend, with Old West artifacts, mining history, and desert lore.

smldm.org

Heard Museum

2301 N Central Ave
Phoenix, AZ 85004
(602) 252-8840

Focuses on Native American art and culture, with powerful exhibits and one of the most respected collections in the country.

<https://heard.org>

Musical Instrument Museum

4725 E Mayo Blvd
Phoenix, AZ 85050
(480) 478-6000

A unique global museum with 15,000+ instruments from nearly 200 countries—the largest of its kind in the world.

<http://mim.org>

Arizona Science Center

600 E Washington St
Phoenix, AZ 85004
(602) 716-2000

Hands-on science museum with interactive exhibits, IMAX theater, and STEM programs, great for families.

<https://azscience.org/>

Children's Museum of Phoenix

215 N 7th St
Phoenix, AZ 85034
(602) 253-0501

One of the top children's museums in the U.S., featuring interactive play-based learning exhibits.

<https://childrensmuseumofphoenix.org/>

Penske Racing Museum

7125 E Chauncey Ln
Phoenix, AZ 85054
(480) 538-4444

Showcases historic race cars, trophies, and motorsports history tied to Team Penske.

<http://www.penskeracingmuseum.com>



Arizona Military Museum

5636 E McDowell Rd

Phoenix, AZ 85008

(602) 267-2676

Covers Arizona's military history with artifacts, uniforms, and exhibits from various wars.

dema.az.gov/army-national-guard/papago-park/arizona-military-museum

Arizona Capitol Museum

1700 W Washington St

Phoenix, AZ 85007

(602) 926-3620

Located in the historic capitol building, highlighting Arizona's political and territorial history.

azcapitolmuseum.gov

Martin Auto Museum & Event Center

4320 W Thunderbird Rd

Glendale, AZ 85306

(602) 298-2377

Large collection of classic, exotic, and vintage cars, plus themed exhibits.

www.martinautomuseum.com

Arizona Museum of Natural History

53 N Macdonald

Mesa, AZ 85201

(480) 644-2230

A favorite for families, featuring dinosaurs, fossils, and Southwest archaeology, including a recreated desert town and flash-flood simulation.

www.azmnh.org

Mesa Contemporary Arts Museum

1 E Main St

Mesa, AZ 85201

(480) 644-6500

A free museum inside the Mesa Arts Center showcasing modern and contemporary art, rotating exhibits, and local artists.

www.mesaartscenter.com/index.php/museums/mesa-contemporary-arts

ASU Art Museum

51 E 10th St

Tempe, AZ 85281

(480) 965-2787

A university museum known for experimental and socially focused contemporary art, often highlighting emerging artists and global themes.

asuartmuseum.asu.edu

Pueblo Grande Museum & Archaeological Park

4619 E Washington St

Phoenix, AZ 85034

(602) 495-0901

An outdoor/indoor museum preserving ancient Hohokam ruins and canal systems, offering trails, artifacts, and archaeology exhibits

www.phoenix.gov/pueblogrande

Hall of Flame Museum of Firefighting

6101 E Van Buren St

Phoenix, AZ 85008

(602) 275-3473

One of the largest firefighting museums in the world, with historic fire engines, gear, and memorials honoring firefighters.

www.hallofflame.org/

Commemorative Air Force Airbase Arizona Museum

2017 N Greenfield Rd

Mesa, AZ 85215

(480) 924-1940

Aviation museum with WWII-era aircraft, flight exhibits, and restored warplanes, some still operational.

www.azcaf.org



Hiking Trails

Lake Overlook Trail

16705 E Ave of the Fountains
Fountain Hills, AZ

Easy–moderate | ~2 miles

Quick climb with great views of Fountain Hills, including the famous fountain and surrounding desert.

Adero Canyon Trailhead

14800 N Eagle Ridge Dr
Fountain Hills, AZ

Easy–moderate | ~2 miles

Main access point to the preserve with several scenic routes, restrooms, and parking.

Fountain Hills McDowell Mountain Preserve

N Eagle Ridge Dr
Fountain Hills, AZ

All level | 8+ miles of connected trails

Large trail network through Sonoran Desert with mountain views and saguaro forests.

McDowell Mountain Regional Park

16300 N McDowell Mountain Park Dr
Fountain Hills, AZ

All level | 8+ miles of connected trails

Large trail network through Sonoran Desert with mountain views and saguaro forests.

Western Loop Trail South

McDowell Mtn Preserve
N Eagle Ridge Dr
Fountain Hills, AZ

Moderate–hard | ~2–4 miles (varies by route)

A steeper, more rugged section of the preserve with elevation gain and quieter paths compared to the main trails.

Golden Eagle Trailhead (Preserve access)

Approx. Golden Eagle Blvd
Fountain Hills, AZ

Easy–moderate | Connects to multiple trails

A quieter northern access point to the preserve, less crowded than Adero.

Dixie Mine Trail (to Thompson Peak routes)

14357 E Desert Tortoise Trail
Fountain Hills, AZ

Easy to very hard (if extended) | 2.5 miles (basic) up to 10+ miles with extensions

Starts easy but can connect to long, challenging climbs toward Thompson Peak—good for scaling your hike length.

Lost Dog Wash Trail

124th St & Via Linda
Scottsdale, AZ

Moderate | ~4 miles (loop options)

Popular loop with rolling terrain, ridge views, and diverse desert scenery.

Sunrise Trailhead

12101 N 145th Way
Scottsdale, AZ

Moderate | ~3.5–4 miles

Leads to Sunrise Peak with panoramic views—one of the best “effort vs reward” hikes nearby.

Trail Head Preserve - McDowell Mountains

18333 N Thompson Peak Pkwy
Scottsdale, AZ

Easy to hard | Multiple routes

Well-maintained trails with excellent signage and sweeping views of the valley.

Gateway Trailhead - McDowell Sonoran Preserve

18333 N Thompson Peak Pkwy
Scottsdale, AZ

Easy to hard | Many options (1–10+ miles)

One of the most popular trailheads with access to diverse and scenic desert hikes.



Nearby Attractions

Fountain Hills Library

12901 N La Montana Dr
Fountain Hills, AZ 85268
(480) 837-5037

Storytime, activity computers, and kid-friendly programs—great break from the heat.

mclidaz.org

Fountain Hills Desert Botanical Garden

11300 N Fountain Hills Blvd
Fountain Hills, AZ 85268
(480) 816-5100

Small, peaceful garden showcasing native Sonoran Desert plants and wildlife.

www.experiencefountainhills.org

Fountain Hills Theater

11445 N Saguaro Blvd
Fountain Hills, AZ 85268
(480) 837-9661

Local theater with year-round plays, musicals, and community performances.

fhtaz.org

Taliesin West

12621 N Frank Lloyd Wright Blvd
Scottsdale, AZ 85259
(480) 627-5340

Frank Lloyd Wright's winter home and architecture school with guided tours.

franklloydwright.org/taliesin-west/

Southwest Wildlife Conservation Center

27026 N 156th St
Scottsdale, AZ 85262
(480) 471-9109

Wildlife rescue sanctuary featuring bears, wolves, and other native animals (guided tours only).

www.southwestwildlife.org

Arizona Boardwalk

9500 E Via De Ventura
Scottsdale, AZ 85256
(480) 291-8000

Entertainment complex with attractions like aquariums, exhibits, and family activities.

www.azboardwalk.com

Butterfly Wonderland

9500 E Via De Ventura
Scottsdale, AZ 85256
(480) 800-3000

Walk-through butterfly rainforest with thousands of butterflies—super engaging for younger kids.

butterflywonderland.com

OdySea Aquarium (Scottsdale/East Valley edge)

9500 E Via De Ventura
Scottsdale, AZ 85256
(480) 800-8000

Largest aquarium in the Southwest with penguins, sharks, and interactive exhibits.

www.odyseaaquarium.com

Tempe Center for the Arts

700 W Rio Salado Pkwy
Tempe, AZ 85281
(480) 350-2822

Concerts, theater, art exhibits, and lakefront architecture.

www.tempe.gov/government/community-services/tempe-center-for-the-arts

Schnepf Farms

24810 S Rittenhouse Rd
Queen Creek, AZ 85142
(480) 987-3100

Train rides, petting zoo, festivals, and seasonal events.

www.schnepffarms.com



Radford Racing School

20000 S Maricopa Rd
Chandler, AZ 85226
(800) 998-3611

Drive performance cars on a real track (older teens/adults)
radfordracingschool.com

Makutu's Island (Huge indoor play center for kids)

6919 W Ray Rd
Chandler, AZ 85226
(480) 705-8558

Massive indoor jungle gym, slides, tunnels—great for kids in hot weather.

makutuisland.com

Downtown Gilbert Heritage District

300 N Gilbert Rd
Gilbert, AZ 85234
(480) 816-5100

Restaurants, weekly farmers market, splash pads, and family events.

experiencegilbert.com

Agritopia / Joe's Farm Grill

3000 E Ray Rd
Gilbert, AZ 85296
(480) 563-4745

Farm-to-table dining inside a walkable urban farm community.

www.joesfarmgrill.com

Andretti Indoor Karting & Games (Chandler)

1712 S Cooper Rd
Chandler, AZ 85286
(480) 219-6571

Go-karts, arcade, bowling, VR games, and laser tag—all indoors and air-conditioned.

www.andrettikarting.com/chandler

Round1 Bowling & Arcade (Chandler Fashion Center)

3111 W Chandler Blvd
Chandler, AZ 85226
(480) 219-6571

Bowling, arcade games, karaoke, and crane games—great for teens and kids.

www.round1usa.com

Big Air Trampoline Park (Chandler)

1925 N Arizona Ave
Chandler, AZ 85225
(480) 918-2847

Massive trampoline arena, foam pits, dodgeball, and kids' zones.

www.bigairusa.com

Salt River Tubing (Mesa)

9200 N Bush Hwy
Mesa, AZ 85215
(480) 984-3305

Floating the Salt River with wild horses in the summer

www.saltrivertubing.com

Golfland Sunsplash (Mesa)

155 W Hampton Ave
Mesa, AZ 85210
(480) 834-8319

A large family entertainment center featuring a seasonal water park with slides and pools plus year-round attractions like mini golf, arcade games, and go-karts.

www.golfland.com/mesa/

www.experiencefountainhills.org



Fountain Hills offers a relaxed, small-town lifestyle with a locally focused mix of dining, shopping, and schools. The dining scene features mostly casual, independently owned restaurants centered near the Fountain Hills Fountain, while shopping is convenient and community-oriented with plazas like Plaza Fountainside providing everyday retail and boutique options. Schools are smaller and more personalized, contributing to a tight-knit community feel.

Scan the qr codes for online guides.

DINING

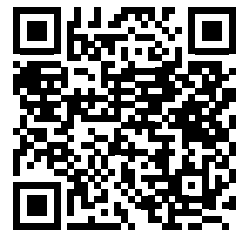

SHOPPING



SCHOOLS

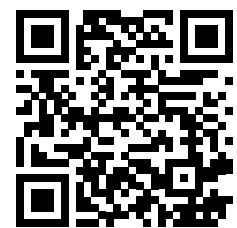

JOIN OUR

MOVING TO FOUNTAIN HILLS, AZ 85268 FACEBOOK GROUP